



FINCHLEY LANE

HENDON, NW4 1BN

£2,200 PER MONTH

A Three bedroom Flat, (using reception as third bedroom) Situated Above Shops on Finchley lane, Laminate Flooring, Close To Transport links and Local Shops. Available from 1/8/2026.



JAYSON
RUSSELL

1ST FLOOR

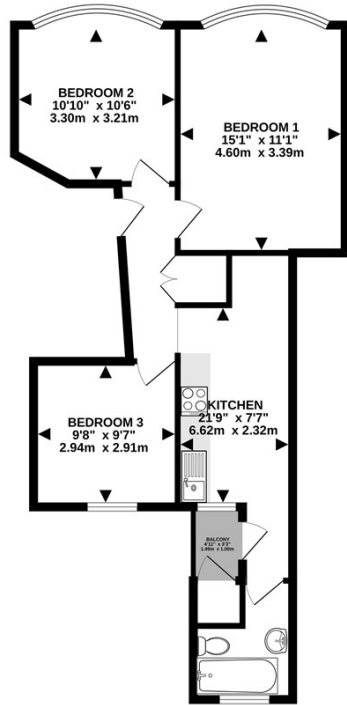

Whilst every attempt has been made to ensure the accuracy of the floorplan contained here, measurements of doors, windows, rooms and any other items are approximate and no responsibility is taken for any error, omission or mis-statement. This plan is for illustrative purposes only and should be used as such by any prospective purchaser. The services, systems and appliances shown have not been tested and no guarantee as to their operability or efficiency can be given.
Made with Metagix C2022

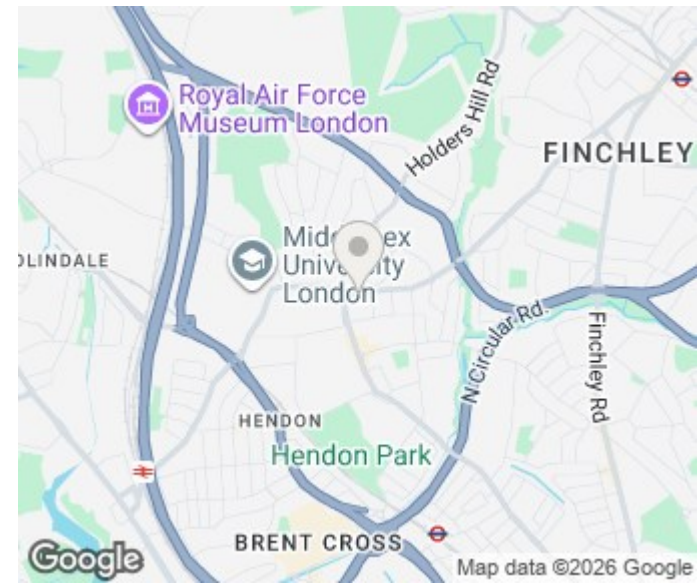

| Energy Efficiency Rating | | |
|---|----------------------------|-----------|
| | Current | Potential |
| Very energy efficient - lower running costs | | |
| (92 plus) A | | |
| (81-91) B | | |
| (69-80) C | | 74 |
| (55-68) D | 59 | |
| (39-54) E | | |
| (21-38) F | | |
| (1-20) G | | |
| Not energy efficient - higher running costs | | |
| England & Wales | EU Directive 2002/91/EC | |

Agents Note: Whilst every care has been taken to prepare these particulars, they are for guidance purposes only. All measurements are approximate and are for general guidance purposes only and whilst every care has been taken to ensure their accuracy, they should not be relied upon and potential buyers/tenants are advised to recheck the measurements

Hendon Lettings
20 Parson Street
London
NW4 1QB

0208 202 1111
info@jaysonrussell.com
www.jaysonrussell.com

